

# NKCN-TYPE

※ Carbide, Nut Type

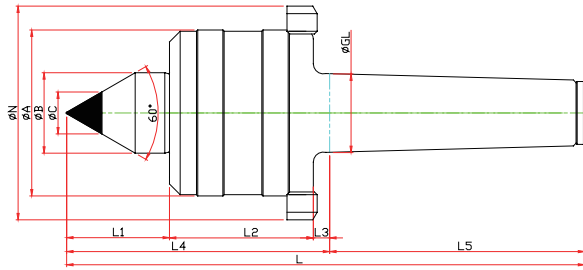

unit:mm/kg

Model	Morse Taper	Dimension											Weight Max. (lbs)	R.P.M Max.	Run out (inch)
		GL	A	B	L1	L2	L3	L4	L5	C	N	L			
<a href="#">LC-3NKCN</a>	NO.3	23,825	52	22	29	42	5	76	80	10	70	156	4188,78	5000	0,00011811
<a href="#">LC-4NKCN</a>	NO.4	31,267	66	32	37	57	6,5	100,5	101,5	14	85	202	5952,48	3800	0,00011811
<a href="#">LC-5NKCN</a>	NO.5	44,399	80	40	45,5	57	6,5	109	129,5	18	98	238,5	7054,79	3400	0,00019685
<a href="#">LC-6NKCN</a>	NO.6	63,348	132	65	65	100	8	173	182	25	165	355	22046,23	1800	0,00019685

※SPECIAL sizes or dimensions are available with quick turnaround

# NKBCN-TYPE

※ SHAFT EXTENTION(Minimize the bite-interference)

※ Carbide, Nut Type

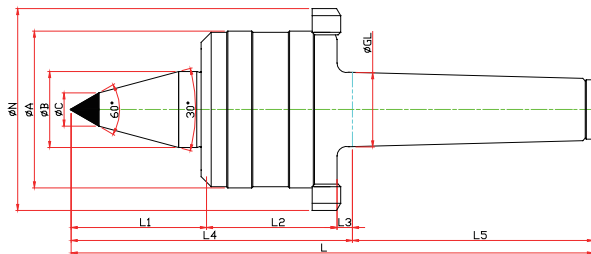

unit:mm/kg

Model	Morse Taper	Dimension											Weight Max. (lbs)	R.P.M Max.	Run out (inch)
		GL	A	B	L1	L2	L3	L4	L5	C	N	L			
<a href="#">LC-3NKBCN</a>	NO.3	23,825	52	22	48	42	5	95	80	10	70	175	4188,78	5000	0,00011811
<a href="#">LC-4NKBCN</a>	NO.4	31,267	66	32	53	57	6,5	116,5	101,5	14	85	218	5952,48	3800	0,00011811
<a href="#">LC-5NKBCN</a>	NO.5	44,399	80	40	65,5	57	6,5	129	129,5	18	98	258,5	7054,79	3400	0,00019685
<a href="#">LC-6NKBCN</a>	NO.6	63,348	132	65	78	100	8	186	182	25	165	368	22046,23	1800	0,00019685

※SPECIAL sizes or dimensions are available with quick turnaround